

PROFESSIONAL SERIES. IN COMPOSITE MATERIAL, HANDLE AND HEAD IN SHOCKPROOF RUBBER. OPERATING LEVER, CHANGE OF ROTATION AND SPEED..

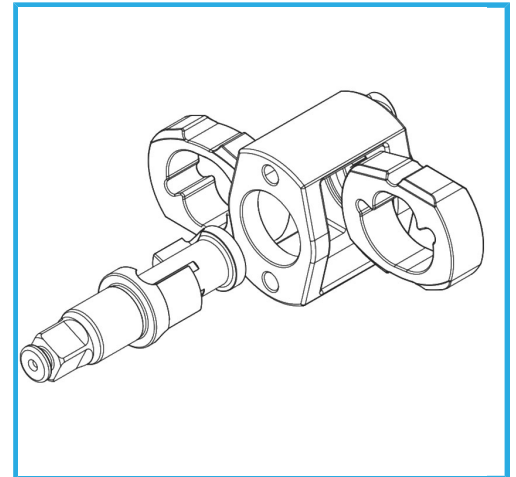

Speed	7800 rpm
Torque	678 Nm 500 lb-ft
Avg air cons.	136 l/min 4.8 SCFM
Working pressure	6 bar 90 psi
Air inlet	1/4"
Net weight	1,2 kg
Gross weight	1,33 kg
EAN Code	8012667346287

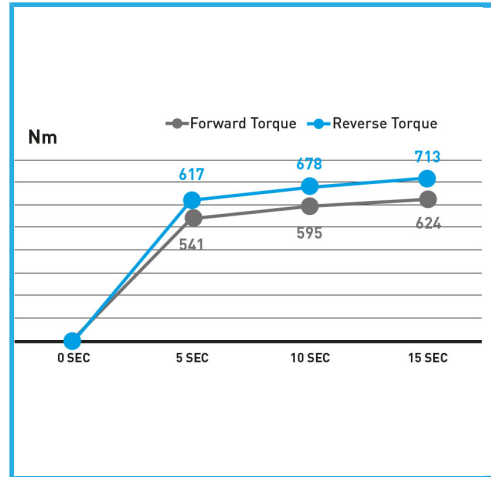

Box



1/2"