

SINGLE GUIDE. INTEGRAL JAWS, CONCENTRIC CLAMPING, EQUIPPED WITH 1 SERIES CONSISTING OF 4 INTERNAL JAWS, 1 SERIES CONSISTING OF 4..

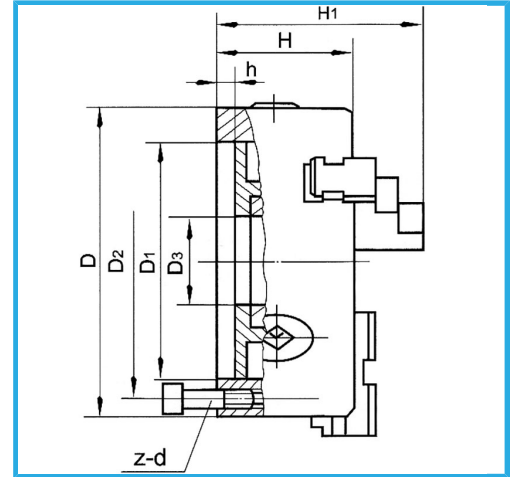

|                       |               |
|-----------------------|---------------|
| D1                    | 206 mm        |
| D2                    | 226 mm        |
| D3                    | 80 mm         |
| H1                    | 124 mm        |
| H                     | 80 mm         |
| h                     | 5 mm          |
| z-d                   | 3-M12 mm      |
| <b>Spanner square</b> | 12 mm         |
| A - A1                | 6 - 110 mm    |
| B - B1                | 80 - 250 mm   |
| C - C1                | 90 - 250 mm   |
| <b>Net weight</b>     | 27,2 kg       |
| <b>Gross weight</b>   | 28,10 kg      |
| <b>EAN Code</b>       | 8012667398088 |

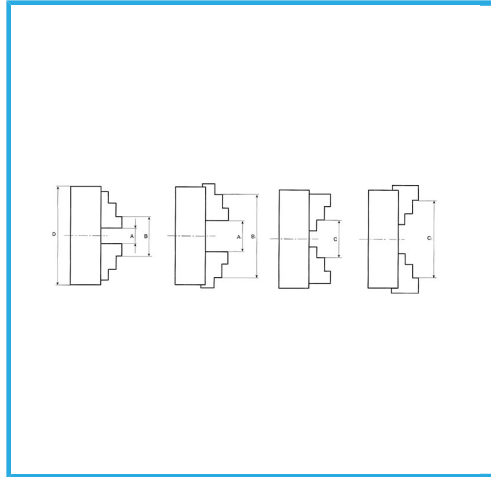

Box



Wooden Box



Cast Iron