

**SINGLE GUIDE. INTEGRAL JAWS, CONCENTRIC CLAMPING, EQUIPPED WITH 1 SERIES CONSISTING OF 4 INTERNAL JAWS, 1 SERIES CONSISTING OF 4..**

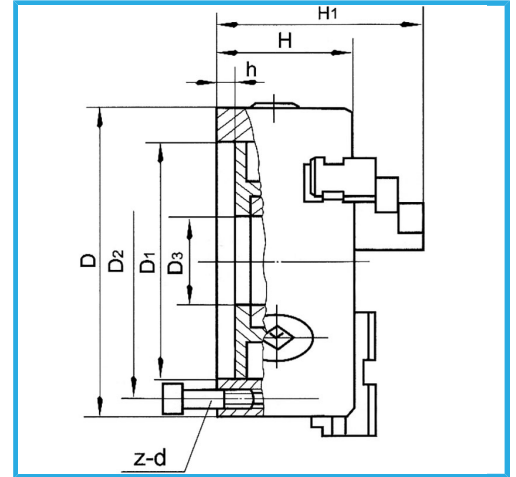

<b>D1</b>	130 mm
<b>D2</b>	142 mm
<b>D3</b>	45 mm
<b>H1</b>	95 mm
<b>H</b>	65 mm
<b>h</b>	5 mm
<b>z-d</b>	3-M8 mm
<b>Spanner square</b>	10 mm
<b>A - A1</b>	3 - 55 mm
<b>B - B1</b>	50 - 160 mm
<b>C - C1</b>	55 - 145 mm
<b>Net weight</b>	8,6 kg
<b>Gross weight</b>	9,00 kg
<b>EAN Code</b>	8012667398064

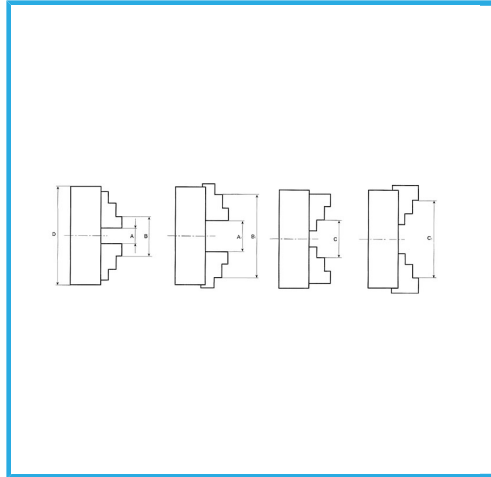

Box



Wooden Box



Cast Iron