

WITH SINGLE GUIDE, SINGLE GUIDE, EQUIPPED WITH 3 INTERNAL - EXTERNAL REVERSIBLE HARD JAWS, CLAMPING KEY AND JAW-FIXING SCREWS,...

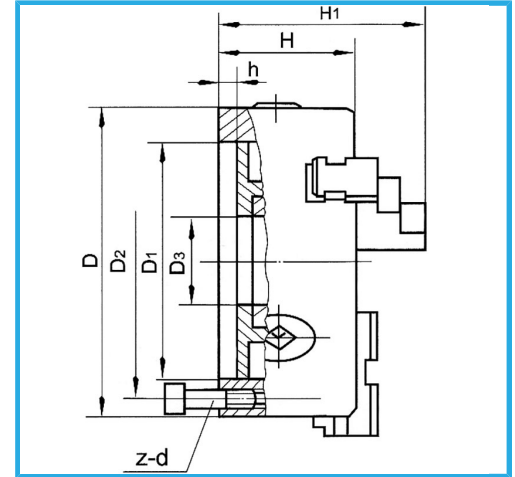

D1	270 mm
D2	290 mm
D3	100 mm
H1	153,5 mm
H	95 mm
h	11 mm
z-d	3-M16 mm
Spanner square	13 mm
A - A1	11,5 - 145 mm
B - B1	95 - 320 mm
C - C1	110 - 320 mm
Net weight	42,4 kg
Gross weight	43,00 kg
Packaging dimensions	390x390x250h mm
EAN Code	8012667397302

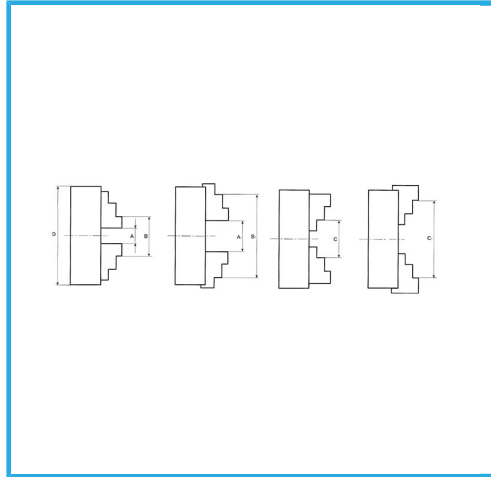

Box



Wooden Box



Cast Iron