

WITH SCREW CONTROL, FLANGE CONNECTION, REVERSIBLE SIMPLE GUIDE JAWS FOR INTERNAL AND EXTERNAL GRIPPING. EQUIPPED WITH JAW KEY...

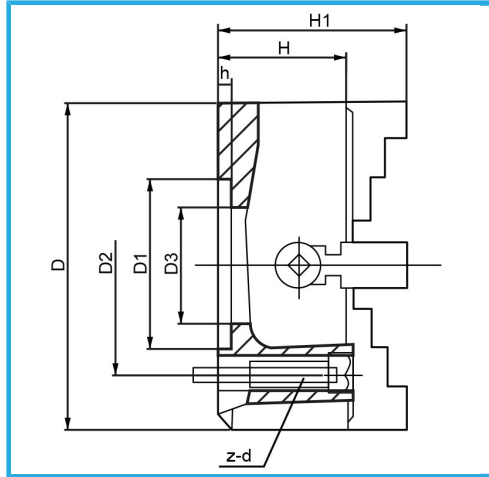

D	160 mm
D1	65 mm
D2	95 mm
D3	55 mm
H1	103 mm
H	75 mm
h	5 mm
z-d	4-M10 mm
Spanner square	10 mm
Net weight	10 kg
Gross weight	10,50 kg
EAN Code	8012667398200
Packaging dimensions	210x210x195 h mm



Box



Wooden Box



Cast Iron