

WITH SCREW CONTROL, FLANGE CONNECTION, REVERSIBLE SIMPLE GUIDE JAWS FOR INTERNAL AND EXTERNAL GRIPPING. EQUIPPED WITH JAW KEY...

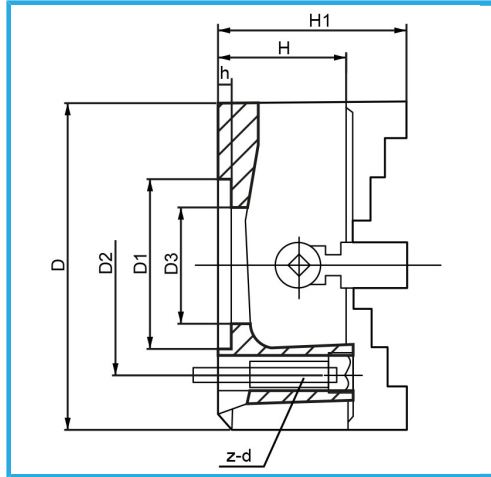

D	250 mm
D1	110 mm
D2	130 mm
D3	100 mm
H1	131 mm
H	90 mm
h	6 mm
z-d	4-M12 mm
Spanner square	12 mm
Net weight	23 kg
Gross weight	24,00 kg
EAN Code	8012667398224
Packaging dimensions	310x310x220 h mm



Box



Wooden Box



Cast Iron