

WITH SCREW CONTROL, FLANGE CONNECTION, REVERSIBLE SIMPLE GUIDE JAWS FOR INTERNAL AND EXTERNAL GRIPPING. EQUIPPED WITH JAW KEY...

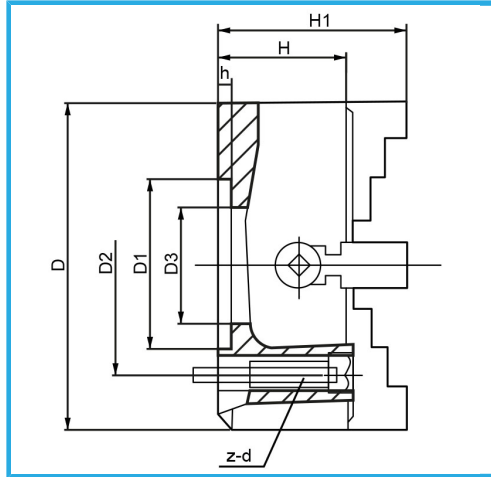

D	200 mm
D1	80 mm
D2	112 mm
D3	70 mm
H1	119 mm
H	80 mm
h	6 mm
z-d	4-M10 mm
Spanner square	10 mm
Net weight	14,5 kg
Gross weight	15,20 kg
EAN Code	8012667398217
Packaging dimensions	265x265x210 h mm



Box



Wooden Box



Cast Iron