

WITH SCREW CONTROL, FLANGE CONNECTION, REVERSIBLE SIMPLE GUIDE JAWS FOR INTERNAL AND EXTERNAL GRIPPING. EQUIPPED WITH JAW KEY...

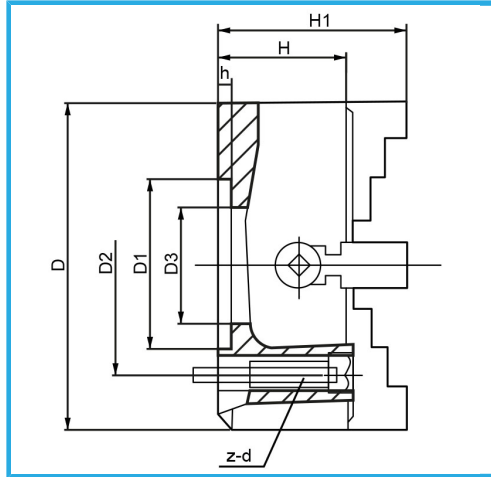

D	320 mm
D1	140 mm
D2	165 mm
D3	115 mm
H1	152 mm
H	102 mm
h	16 mm
z-d	4-M16 mm
Spanner square	14 mm
Net weight	43 kg
Gross weight	44,50 kg
EAN Code	8012667398231
Packaging dimensions	390x420x200 h mm



Box



Wooden Box



Cast Iron